

StarLeaf PT Mini

Installation Guide

February 03, 2017



Contents

About the PT Mini codec	3
The connectors	3
Codec dimensions	4
About the touchscreen phone	5
How to install PT Mini	6
Provisioning the PT Mini 3020 through the Portal	8
QuickConnect	9
Legal information	10
Third party software acknowledgments	10
Disclaimers and notices	10

About the PT Mini codec

The connectors

The figure below shows the connectors on the Personal Telepresence 3020 (PT Mini) codec.

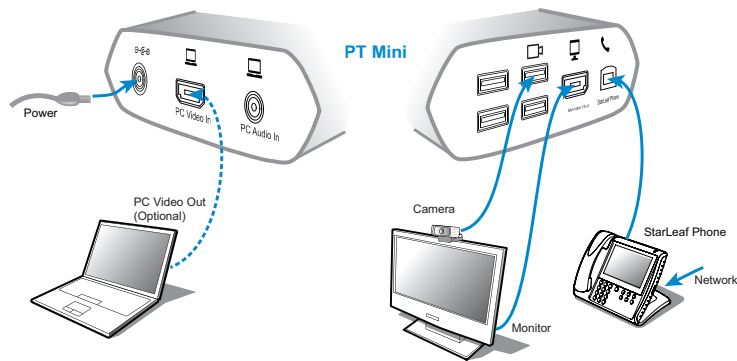

The table below describes the connectors:

Connector	Description
Power	Connect to the supplied AC/DC adaptor
PC Video In	Optionally connect a laptop or PC for video, instead of a monitor
PC Audio In	Port not currently in use
USB x3	Reserved USB connectors
Camera input	USB connector. You connect the camera to this port
Monitor Out HDMI	HDMI connector. Monitor Out connector outputs video (1080p60 only) to the screen. If you are also connecting a PC or laptop, connect it to HDMI port PC Video In
StarLeaf Phone	Connect to the Personal Telepresence port on the rear of the StarLeaf Phone 2120 to allow communication between the phone and the PT Mini codec

Codec dimensions

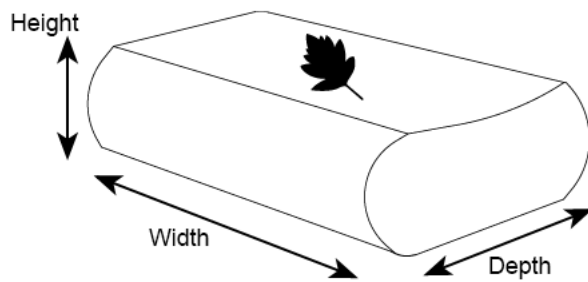

Dimension	Metric	American
Width	165 mm	6.5 in.
Depth	110 mm	4.3 in.
Height	40 mm	1.6 in.

About the touchscreen phone

Every PT Mini comes with a touchscreen phone: the StarLeaf Phone 2120. You use the touchscreen phone as the means for making and controlling video calls with Personal Telepresence. Through the touchscreen phone, you can access the directory and contacts. You can use the phone to create ad hoc conferences, and to add and remove participants.



The StarLeaf Phone 2120

How to install PT Mini

Before installing a StarLeaf product, read the safety information at www.starleaf.com/safety.

Pre-requisites

Before installing the StarLeaf PT Mini 3020, ensure you have the following:

- A StarLeaf Cloud account
- A monitor that supports a 1080p60 input format
- Network connection routable to the public Internet

Unpack the room system. The package contents are:

- PT Mini product bundle, including:
 - PT Mini 3020 codec
 - Phone 2120
 - Logitech C920 USB camera
- Installation sheet
- Power supply
- Cables
 - USB cable
 - Audio cable

Note: The audio cable is a spare cable and is not necessary for installation of the PT Mini
 - HDMI video cable (two)
- Video adaptors
 - HDMI to DVI-D cables (two)

Positioning the PT Mini

1. Ensure you have chosen an appropriate installation site:
 - The PT Mini must be accessible with all cables easily connected
 - You must provide ventilation for the PT Mini; leave a space of at least 10cm (4 inches) behind, in front, and to the left and right of the PT Mini. Avoid installing it near a heat source such as a radiator and avoid placing it in direct sunlight
 - The plug that connects AC power to the AC/DC adaptor is the main disconnect device for the PT Mini and must always be easily accessible.
 - Use a grounded AC power outlet for the PT Mini. The PT Mini must be connected to the AC/DC adaptor
2. Place the unit on a firm horizontal surface. If you intend to mount the unit, refer to [Codec dimensions \(p4\)](#).

Connecting cables to the PT Mini

1. Connect the USB cable into the **Personal Telepresence** port on the Phone 2120 and the **StarLeaf Phone** port on the PT Mini. The network port on the Phone 2120 is marked with this symbol:



Note: The Phone 2120 must connect directly to the PT Mini; do not connect the phone via a switch to the PT Mini.

2. Using an HDMI video cable, connect the monitor to the **Monitor Out** port on the PT Mini.
3. Connect the camera to the USB port denoted by the  symbol and mount the camera to the top of the monitor.
4. If you want to connect a laptop or PC to the PT Mini as well, use the HDMI cable to connect your PC to the **PC Video In** port on the PT Mini.
5. Using the supplied power adaptor, connect power to the PT Mini.

Mounting the camera

StarLeaf recommends that when you mount the camera, you place it at the top of the screen, as opposed to the base. This makes it easier for you to see the participants on the screen while still appearing to make eye contact.

Connecting to the Cloud

Provisioning the PT Mini 3020 through the Portal

Either you or your reseller can register the PT 3020 using the StarLeaf Portal. To do this:

1. In the StarLeaf Portal, choose **Users > Add user**. You can see the **Add user** page:

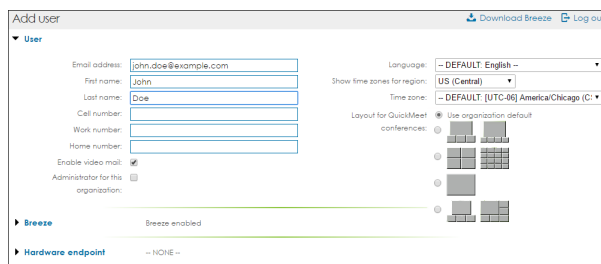

2. Provide the following user information:
 - **Email address:** A user's email address is the unique identifier for that user. They receive an activation email to this email address. The user is not able to change the email address and uses it to log in to the StarLeaf Portal. The email address is a video address that any other StarLeaf user can dial to reach this user
 - **First and Last name:** A user's first and last name are displayed on the StarLeaf device. The names are also used in the directory, in voice and videomail, and when sending invites to conferences and invites to use StarLeaf Breeze
 - **Optional contact details:** Cell, Work, and Home numbers. If specified, these appear in the company address book
 - **Enable video mail:** Ensure that this is selected in order for users to receive voicemail, or video mail
 - **Optional overrides for language and time zone:** the time zone is used for StarLeaf devices and for StarLeaf voice and video messages
3. In the **Hardware endpoint** section, for **Type** choose *StarLeaf PT 3050, PT Mini 3020, or Phone 2120*.
4. Choose whether or not to send the account settings by email.
5. Click **Apply** to submit the configuration. The Portal generates a unique QuickConnect code. You enter this code on the touchscreen controller.

QuickConnect

The Phone 2120 receives power from the PT Mini. The first time it starts up it displays the screen shown below. Enter your StarLeaf QuickConnect code.



The Phone 2120 displays the user name and extension number as per your StarLeaf Cloud account. This is the home screen of the phone. The PT Mini 3020 is ready to make and receive calls. An example home screen is shown below.

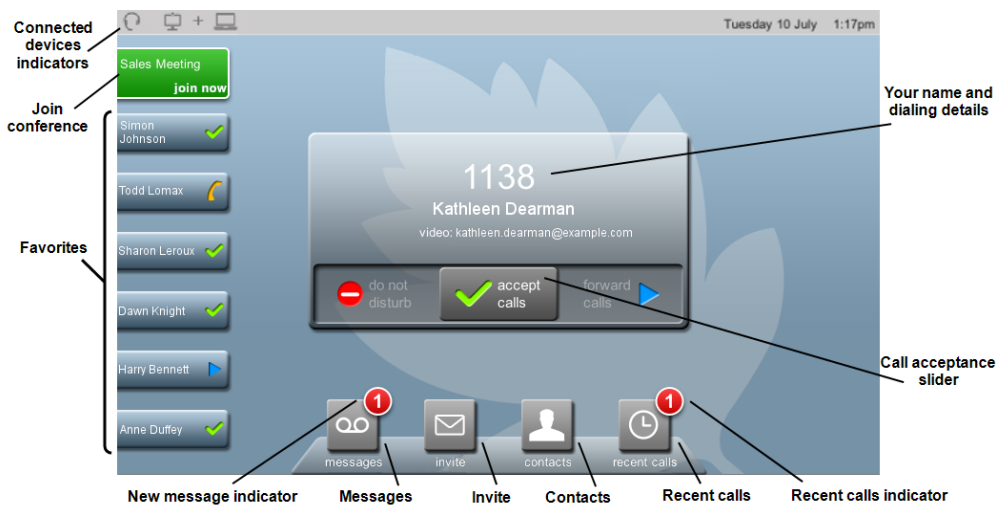

Legal information

Third party software acknowledgments

Acknowledgments of third-party software are available at:

www.starleaf.com/support/legal

Disclaimers and notices

Copyright © StarLeaf 2017. All rights reserved.

This guide may not be copied, photocopied, translated, reproduced, or converted into any electronic or machine-readable form in whole or in part without prior written approval of StarLeaf Limited.

StarLeaf Limited reserves the right to revise this documentation and to make changes in content from time to time without obligation on the part of StarLeaf Limited to provide notification of such revision or change.

StarLeaf Limited provides this documentation without warranty, term, or condition of any kind, either implied or expressed, including, but not limited to, the implied warranties, terms or conditions of merchantability, satisfactory quality, and fitness for a particular purpose. StarLeaf Limited may make improvements or changes to the product(s) and/or the program(s) described in this documentation at any time. All other product and company names herein may be trademarks of their respective owners.